

**This electronic collection of documents is provided
for the convenience of the user
and is Not a Certified Document –**

**The documents contained herein were originally issued
and sealed by the individuals whose names and license
numbers appear on each page, on the dates appearing
with their signature on that page.**

**This file or an individual page
shall not be considered a certified document.**

VICINITY MAP

GASTON COUNTY NC

TIP No.	WBS NO.
W - 5712P	44858.3.16

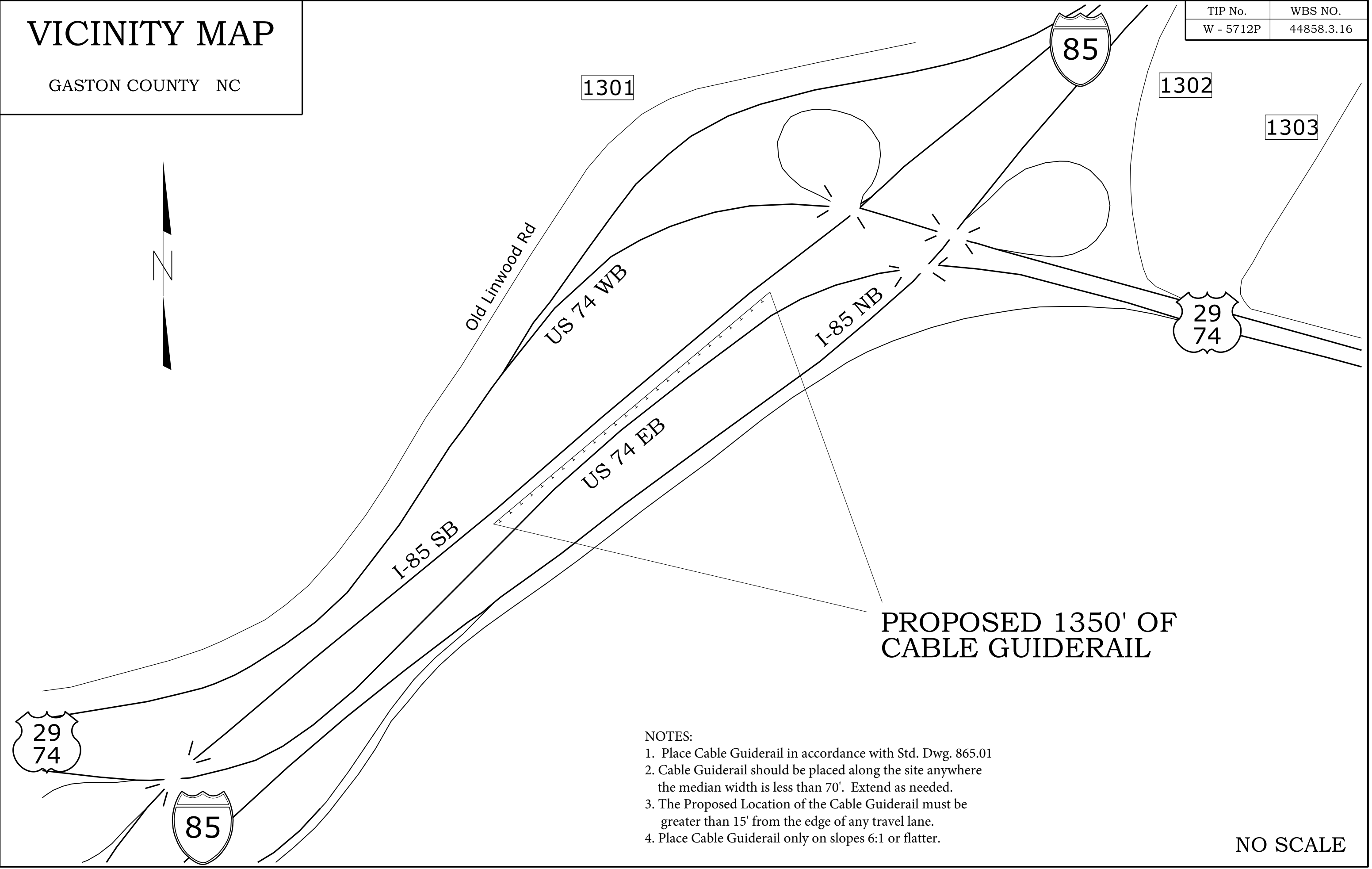

**PROPOSED 1350' OF
CABLE GUIDERAIL**

NOTES:

1. Place Cable Guiderail in accordance with Std. Dwg. 865.01
2. Cable Guiderail should be placed along the site anywhere the median width is less than 70'. Extend as needed.
3. The Proposed Location of the Cable Guiderail must be greater than 15' from the edge of any travel lane.
4. Place Cable Guiderail only on slopes 6:1 or flatter.

NO SCALE

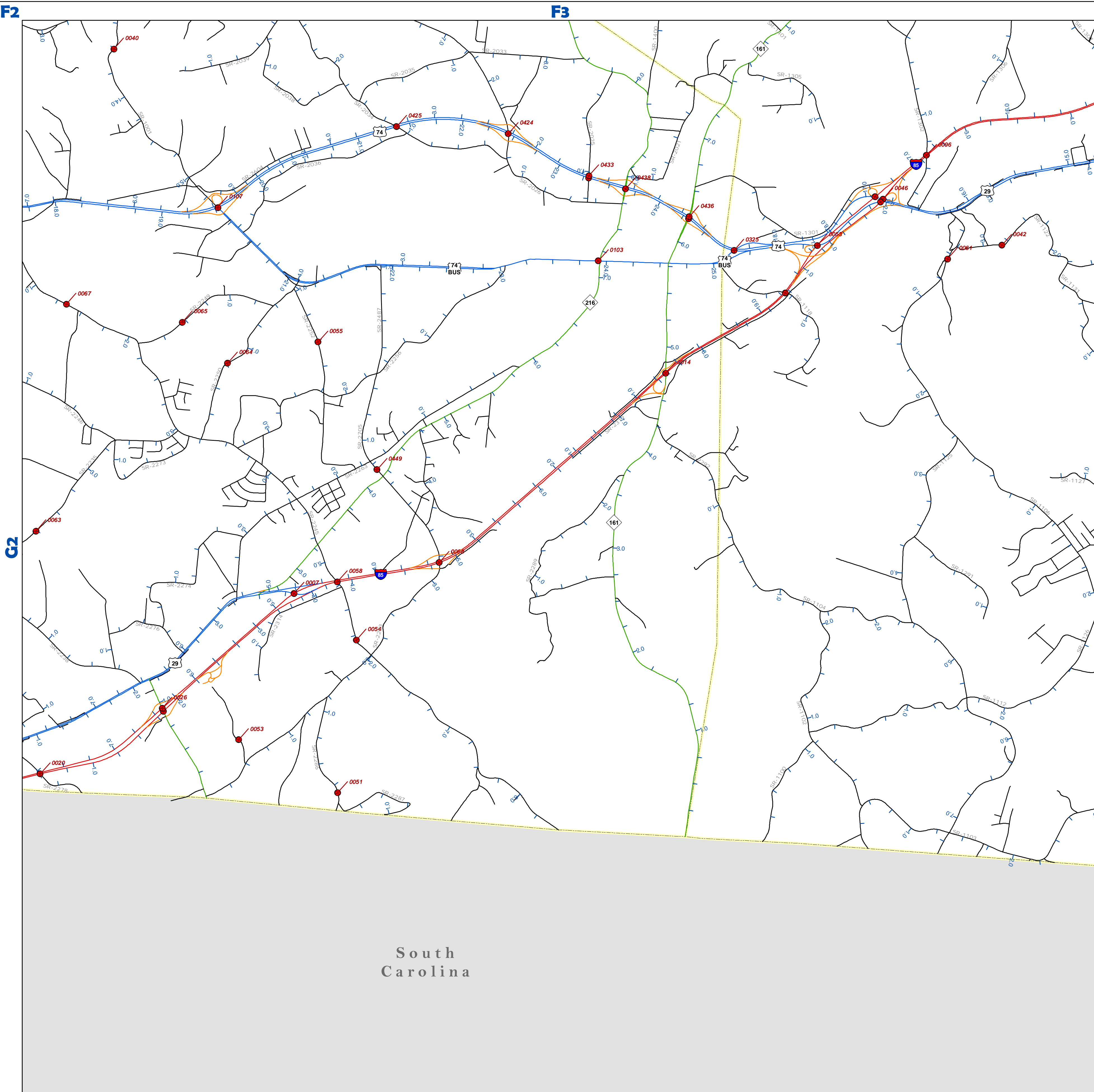

Division 12 Atlas Milepost Map G3

- Bridges
- NC Routes
- Interstates
- Secondary Routes
- US Routes
- Ramps
- County Boundary

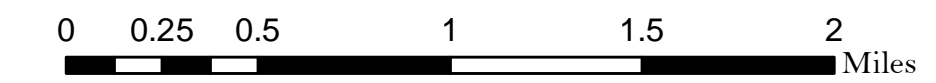
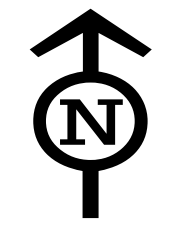

Routes are hatched every 0.25 miles and are label every mile.
Only routes over one mile have hatching.

Maps current as of 2017 4th Quarter LRS Publication.

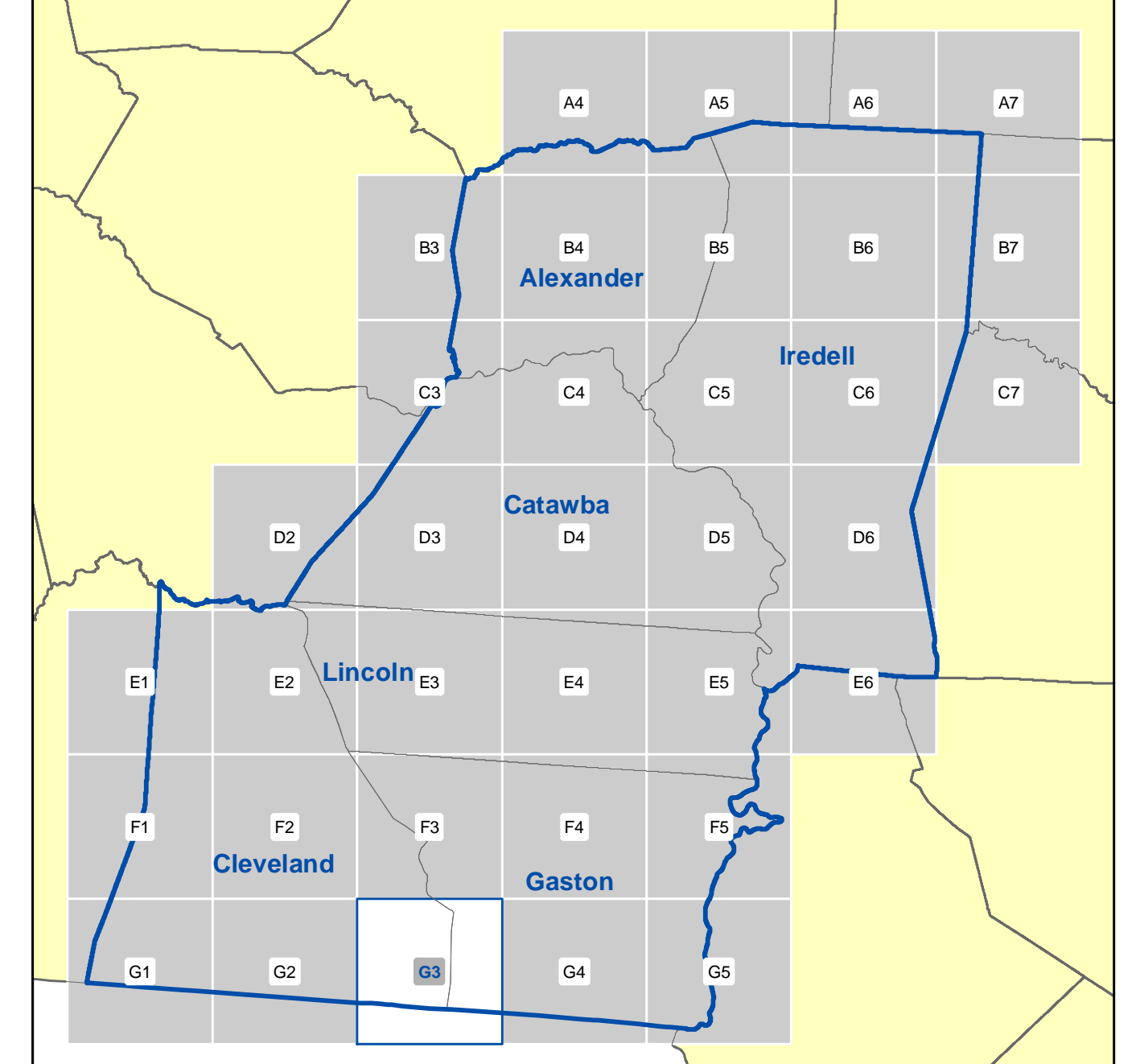

Guardrail End Unit Summary

TIP: W-5712P

WBS: 44858.3.16

Description: Replace / Repair Existing Guardrail End Units & Install Cable Guiderail

Locations: US 74 from Harmon Rd to I-85

I-85 from SC State Line to US 321 (Exit 17)

County	Route	Direction	Location	Milepost (County)	Interstate Mile Marker	GREU, Type TL-3 (EA)	Buried in Cut (EA)	Comments
Cleveland	US 74	EB	Shoulder	18.8		1		Replace with TL-3
Cleveland	US 74 - On Ramp	EB	Shoulder	19.8		1		From 74 Business
Cleveland	US 74 - On Ramp	EB	Shoulder	22.7		1		From SR 2026
Cleveland	US 74	EB	Shoulder	23.2		1		Approach End at Bridge # 433
Cleveland	US 74	EB	Median	23.2		1		Approach End at Bridge # 433
Cleveland	US 74	EB	Shoulder	24.0		1		Replace with TL-3
Cleveland	US 74	EB	Shoulder	24.3		1		Approach End at Bridge # 436
Cleveland	US 74	EB	Median	24.3		1		Approach End at Bridge # 436
Cleveland	US 74 - On Ramp	EB	Shoulder	24.5		1		From NC 161
Gaston	US 74 - Off / I-85 On Ramp	EB	Shoulder	0.8		1		Approach End at Bridge # 313
Gaston	US 74 - Off Ramp	WB	Shoulder	18.0		1		Toward 74 Business (WB)
Gaston	US 74 - Off Ramp	WB	Shoulder	18.1		1		Approach End at Bridge # 325
Gaston	US 74 - Off Ramp	WB	Median	18.1		1		Approach End at Bridge # 325
Cleveland	US 74	WB	Shoulder	0.4		1		Approach End at Bridge # 436
Cleveland	US 74	WB	Median	0.4		1		Approach End at Bridge # 436
Cleveland	US 74 - On Ramp	WB	Shoulder	0.5		1		From NC 161
Cleveland	US 74	WB	Shoulder	1.3		1		Approach End at Bridge # 433
Cleveland	US 74	WB	Median	1.3		1		Approach End at Bridge # 433
Cleveland	I-85	NB	Median	0.0	0.0	1		Replace with TL-3 (State Line)
Cleveland	I-85	NB	Shoulder	0.1	0.1		1	Adjust Height & Rebury
Cleveland	I-85	NB	Shoulder	0.2	0.2		1	Adjust Height & Rebury
Cleveland	I-85	NB	Shoulder	0.5	0.5		1	Adjust Height & Rebury
Cleveland	I-85	NB	Shoulder	1.0	1.0		1	Replace & Adjust Height
Cleveland	I-85	NB	Shoulder	1.5	1.5		1	Adjust Height & Rebury
Cleveland	I-85	NB	Median	1.8	1.8	1		Replace with TL-3
Cleveland	I-85	NB	Median	2.0	2.0	1		Replace with TL-3
Cleveland	I-85	NB	Shoulder	3.4	3.4		1	Adjust Height & Rebury
Cleveland	I-85	NB	Shoulder	3.8	3.8	1		Replace BIC with TL-3
Cleveland	I-85	NB	Shoulder	4.2	4.2		1	Adjust Height & Rebury
Cleveland	I-85	NB	Shoulder	4.5	4.5		1	Adjust Height & Rebury
Cleveland	I-85 - On Ramp	NB	Shoulder	4.8	4.8	1		From SR 2283 (Dixon Sch Rd)
Cleveland	I-85 - On Ramp	NB	Shoulder	4.9	4.9	1		From SR 2283 (Dixon Sch Rd)
Cleveland	I-85	NB	Shoulder	7.3	7.3	1		Replace BIC with TL-3
Cleveland	I-85	NB	Shoulder	8.1	8.1	1		Replace with TL-3
Gaston	I-85	NB	Shoulder	0.3	8.5	1		Replace with TL-3
Gaston	I-85	NB	Shoulder	0.7	8.9	1		Approach to Brdg under SR 1118
Gaston	I-85	NB	Median	0.7	8.9	1		Approach to Brdg under SR 1118
Gaston	I-85	NB	SHLDR	1.45	9.67	1		Upgrade Old End Unit
Gaston	I-85	NB	SHLDR	4.68	12.90	1		Old Unit along Exit 13 On Ramp
Gaston	I-85	NB	SHLDR	5.57	13.79	1		Upgrade Old End Unit at OH Sign
Gaston	I-85	NB	SHLDR	7.53	15.75	1		Upgrade Old End Unit at Brdg. 118
Gaston	I-85	SB	Median	18.1	9.5	1		Approach to Bridge # 53
Gaston	I-85	SB	Median	18.1	9.5	1		Approach to Bridge # 53
Cleveland	I-85	SB	Shoulder	1.0	7.2		1	Adjust Height & Rebury
Cleveland	i-85	SB	Shoulder	3.0	5.2	1		Replace BIC with TL-3
Cleveland	I-85	SB	Shoulder	5.2	3.0		1	Replace & Adjust Height
Cleveland	I-85	SB	Shoulder	6.9	1.3		1	Replace & Adjust Height
Cleveland	I-85	SB	Median	7.4	0.8	1		Replace with TL-3
Gaston	I-85	SB	Median	8.2	0	1		Replace with TL-3 (State Line)
Gaston	I-85	SB	SHLDR	13.77	13.96	1		Upgrade Old End Unit at OH Sign
Gaston	I-85	SB	SHLDR	14.72	12.91	1		Upgrade Old End Unit at Brdg. 101
Gaston	I-85	SB	SHLDR	16.50	11.13	1		Upgrade Old End Unit
Gaston	I-85	SB	SHLDR	16.78	10.85	1		Upgrade Old End Unit
Total						42	11	

Cable Guiderail Summary

County	Route	Direction	Location	From MM	To MM	Length (LF)	Anchors	Comments
Gaston	I-85	SB	Median	9.95	10.20	1350	2	Between I-85 SB & US 74 EB Lanes
Total						1350	2	

GUARDRAIL END UNIT SUMMARY

TIP: W-5712W

WBS: 44858.3.23

Description: Replace / Repair Existing Guardrail End Units

Location: US 321 from Gaston / Lincoln Co. Line to I-40 including the I-40 Exit 123 & Exit 125 Ramps

County	Route	Direction	Mile Marker	Existing GREU	GREU, Type TL-3 (EA)	Shoulder or Median	Additional Location Description
LINCOLN	US-321	North	20	BCT	1	Shoulder	Exit 20 Off Ramp (1 of 2)
LINCOLN	US-321	North	20	BCT	1	Shoulder	Exit 20 Off Ramp (2 of 2)
LINCOLN	US-321	North	20	BCT	1	Shoulder	
LINCOLN	US-321	North	20.1	BCT	1	Shoulder	
LINCOLN	US-321	North	21	BCT	1	Shoulder	
LINCOLN	US-321	North	21.3	BCT	1	Shoulder	
LINCOLN	US-321	North	23.3	BCT	1	Shoulder	SR-1294 Bridge overpass
LINCOLN	US-321	North	23.5	BCT	1	Shoulder	
LINCOLN	US-321	North	24	BCT	1	Shoulder	Exit 24 Under bridge
LINCOLN	US-321	North	24	BCT	1	Shoulder	Exit 24 On Ramp
LINCOLN	US-321	North	25.5	BCT	1	Shoulder	
LINCOLN	US-321	North	26	BCT	1	Shoulder	
LINCOLN	US-321	North	27	BCT	1	Shoulder	SR-1338 Bridge overpass
LINCOLN	US-321	North	28	BCT	1	Shoulder	Exit 28 Off Ramp
LINCOLN	US-321	North	28	BCT	1	Shoulder	Exit 28 Under Bridge
LINCOLN	US-321	North	29	BCT	1	Shoulder	
LINCOLN	US-321	North	29.3	BCT	1	Shoulder	
CATAWBA	US-321	North	30	BCT	1	Shoulder	
CATAWBA	US-321	North	30.5	BCT	1	Shoulder	
CATAWBA	US-321	North	31	BCT	1	Shoulder	
CATAWBA	US-321	North	31.7	BCT	1	Shoulder	
CATAWBA	US-321	North	32.3	BCT	1	Shoulder	
CATAWBA	US-321	North	33	MELT	1	Shoulder	
CATAWBA	US-321	North	35	MELT	1	Shoulder	
CATAWBA	US-321	North	35.5	MELT	1	Shoulder	
CATAWBA	US-321	North	37	MELT	1	Shoulder	Exit 37 Off Ramp
CATAWBA	US-321	North	37	MELT	1	Shoulder	Exit 37 Under Bridge
CATAWBA	US-321	North	37	MELT	1	Shoulder	Exit 37 On Ramp
CATAWBA	US-321	North	37.8	MELT	1	Shoulder	
CATAWBA	US-321	North	38.8	MELT	1	Shoulder	
CATAWBA	US-321	North	39.3	MELT	1	Shoulder	
CATAWBA	US-321	North	39.5	MELT	1	Shoulder	
CATAWBA	US-321	North	42	MELT	1	Shoulder	
CATAWBA	US-321	South	42.4	MELT	1	Shoulder	Henry Fork River Bridge
CATAWBA	US-321	South	42	MELT	1	Shoulder	NC 127 Exit 42 Off Ramp
CATAWBA	US-321	South	41.5	MELT	1	Shoulder	
CATAWBA	US-321	South	41.2	MELT	1	Shoulder	
CATAWBA	US-321	South	41	MELT	1	Shoulder	Exit 41 On ramp
CATAWBA	US-321	South	38.5	MELT	1	Shoulder	
CATAWBA	US-321	South	37	MELT	1	Shoulder	NC 10 Bridge
CATAWBA	US-321	South	37	MELT	1	Shoulder	NC 10 on Ramp
CATAWBA	US-321	South	36.5	MELT	1	Shoulder	
CATAWBA	US-321	South	35.2	MELT	1	Shoulder	
CATAWBA	US-321	South	34.5	MELT	1	Shoulder	
CATAWBA	US-321	South	33.8	MELT	1	Shoulder	
CATAWBA	US-321	South	33.2	MELT	1	Shoulder	
CATAWBA	US-321	South	33	BCT	1	Shoulder	Exit 33 On Ramp
CATAWBA	US-321	South	32	BCT	1	Shoulder	
CATAWBA	US-321	South	30.8	BCT	1	Shoulder	
CATAWBA	US-321	South	29.5	BCT	1	Shoulder	
LINCOLN	US-321	South	29.1	BCT	1	Shoulder	
LINCOLN	US-321	South	28	BCT	1	Shoulder	
LINCOLN	US-321	South	28	BCT	1	Shoulder	US 321 B Bridge
LINCOLN	US-321	South	28	BCT	1	Shoulder	Exit 28 On Ramp
LINCOLN	US-321	South	25.5	BCT	1	Shoulder	
LINCOLN	US-321	South	25.2	BCT	1	Shoulder	SR-1267 Bridge overpass
LINCOLN	US-321	South	24.5	BCT	1	Shoulder	
LINCOLN	US-321	South	24.2	BCT	1	Shoulder	
LINCOLN	US-321	South	23.9	BCT	1	Shoulder	
LINCOLN	US-321	South	23	CAT1	1	Shoulder	
LINCOLN	US-321	South	22.5	BCT	1	Shoulder	

LINCOLN	US-321	South	21.8	CAT1	1	Shoulder	
LINCOLN	US-321	South	21.2	BCT	1	Shoulder	
LINCOLN	US-321	South	20.5	BCT	1	Shoulder	
LINCOLN	US-321	South	20	BCT	1	Shoulder	
LINCOLN	US-321	South	20	BCT	1	Shoulder	Exit 20 Ramp
LINCOLN	US-321	South	20	BCT	1	Shoulder	Exit 20 Bridge Approach
CATAWBA	I-40	EB	MP 0.481	TERM END	1	Shoulder	Exit 123b Off Ramp
CATAWBA	I-40	EB	MP 0.481	BCT	1	Median	Exit 123b Off Ramp
CATAWBA	I-40	WB	MP 0.546	TERM END	1	Shoulder	Exit 123b Off Ramp
CATAWBA	I-40	WB	MP 0.426	MELT	1	Median	Exit 123a Off Ramp
CATAWBA	I-40	WB	MP 0.281	TERM END	1	Shoulder	Exit 125 Off Ramp
PROJECT TOTAL					72		